

# FINAL PROGRAM



SAN FRANCISCO

Hilton San Francisco Union Square

ASMH 23<sup>rd</sup> Annual Meeting  
April 28–29, 2017

[www.mohstech.org/annual-meeting](http://www.mohstech.org/annual-meeting)

# THE REVOLUTIONARY QS12 CRYOSTAT

Avantik Biogroup

## The #1 Name in Mohs.

ELIMINATE CHATTER, VENETIAN BLIND & THICK/THIN

UP TO 75% LESS NOISE

ERGONOMICALLY DESIGNED

ADJUSTABLE LED LIGHTING

ULTRA SMOOTH HANDWHEEL OPERATION

PRECISION & ACCURACY

PERFECT SECTIONS

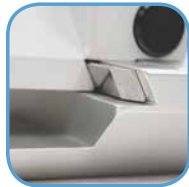

Dovetail Bladeholder



Perfect Sections



Peltier - Fast Freezing



UV Disinfection Option



## The Mohs Laboratory Solution

*Your laboratory... quick, efficient, easy.*

*The QS12 and QS12UV have been the result of extensive research and development over the span of years. From bladeholder to microtome, cryobar to refrigeration... every aspect of the QS12 and QS12UV is unsurpassed in quality and precision. A Perfect Section...it's unmistakable!*

## The Mohs Laboratory Performers



CALL TODAY TO SPEAK TO YOUR **MOHS LAB SPECIALIST** REGARDING ALL OF YOUR MOHS LAB NEEDS!

888.392.8411

[www.avantik-us.com](http://www.avantik-us.com)

 **AVANTIK**  
BIOGROUP

A Business Unit of Belair Instrument Co.

# Table of Contents

General Meeting Information .....	2
2016-2017 Officers and Board Members .....	3
2016-2017 ASMH Committees .....	3
Special Events .....	3
Welcome Messages .....	4
Program-at-a-Glance .....	6
Hotel & Travel Information .....	8
Hilton San Francisco Union Square Floor Map .....	9
Pre-Conference Workshops – Thursday, April 27 .....	10
Scientific Program – Friday, April 28 .....	12
Scientific Program – Saturday, April 30 .....	13
Cryostat and Immunohistochemistry Workshop Details .....	14
2017 Abstract Award Winner .....	15
Thank You .....	16
Exhibit Hall Floor Plan .....	17
Exhibitor Listing .....	18



© 2017  
American Society for Mohs Histotechnology  
No part of this publication may be reproduced without the prior written permission of the ASMH.  
Photos courtesy of Hilton San Francisco Union Square and iStock.

American Society for Mohs Histotechnology  
555 East Wells Street, Suite 1100  
Milwaukee, WI 53202  
Phone: (414) 918-9813  
Fax: (414) 276-3349  
Email: info@mohstech.org  
Website: www.mohstech.org



# General Meeting Information

## On-Site Registration

The ASMH registration desk will be open at the Hilton San Francisco Union Square on the following days and times (subject to change):

Wednesday, April 26: 1:00 pm – 5:00 pm

Thursday, April 27: 6:30 am – 5:00 pm

Friday, April 28: 6:30 am – 5:00 pm

Saturday, April 29: 6:30 am – 4:00 pm

## Contact Hours

The National Society for Histotechnology (NSH) approved the ASMH 23rd Annual Meeting for up to 22.25 Continuing Education Unit Contact Hours. Meeting attendees are responsible for signing-in on the Attendance Record form at the Registration Desk, as well as tracking their session attendance and reporting it directly to the NSH for contact hour credit. There is no fee for this service. Visit [ce.nsh.org](http://ce.nsh.org) to access the contact hour portal. Additional information regarding the portal may be found on the Contact Hour Tracking Sheet in your registration packet. NSH can be reached at (443) 535-4060 or [histo@nsh.org](mailto:histo@nsh.org).

## Certificate of Participation

Please pick up your certificate of participation at the registration desk on Saturday, April 29.

## Use of Mobile Devices

Please ensure that mobile phones, pagers or other electronic devices are silenced during all sessions.

## Lost & Found

Please notify staff at the ASMH Registration Desk if you have lost or found an item during the course of the meeting.



## WiFi Connection Instructions

To access the Internet in meeting spaces:

1. Go to the wireless settings on your device.
2. Select the network SSID “**Mohs2017**” and connect.
  - If you are using a mobile device, a portal page will open automatically in your web browser. If you are using a laptop, you may need to launch a browser for the portal page to appear.
3. On the portal page, enter the access code “**derm**” to log in.

*NOTE: The complimentary wireless service available in guest rooms uses a different network SSID and access code than noted above for the meeting spaces.*

## Special Needs

The ASMH wishes to ensure that no individual with a disability is excluded, denied services, segregated, or otherwise treated differently than other individuals because of auxiliary aids and/or service(s). If you need an auxiliary aid or service(s) identified in the Americans with Disabilities Act, or if you have any health issues for which you may require special accommodations or assistance, please notify the ASMH staff at the Registration Desk.

## Photography and Recording Policy

Photography or video or audio recording of sessions, materials presented in session, or exhibits without express written permission from the ASMH is strictly prohibited. Any photos, video or audio taken by or on behalf of the ASMH of the meeting activities and attendees shall be property of the ASMH.

There will be a professional photographer onsite documenting the meeting and social events. By attending the meeting, you agree to be photographed. Photos may be used in future promotional materials, ASMH publications, websites and social media, or other formats controlled by the ASMH.

## Restriction on Minors

Children under 18 years of age are NOT permitted to enter the Exhibit Hall at any time during the meeting. This restriction includes installation, exhibition and dismantling hours. If children are present, they will be required to leave the hall immediately.



Founded by Mohs surgeon, John Strasswimmer, M.D., Ph.D., in response to the skin cancer crisis of poor people, the mission of Dermatology Medical Missions (DMM) is to coordinate teams of volunteer physicians and related people to travel to medically underserved areas of the world to treat patients and to educate health professionals and care givers. DMM is a non-profit 501c3 organization that exists specifically to save the lives of people with skin diseases, especially skin cancer, delivering hands-on treatment.



**DERMATOLOGY MEDICAL MISSIONS, Inc.**  
*Going Anywhere In The World*  
2605 West Atlantic Avenue, Suite D203  
Delray Beach, FL 33445  
P 561.819.5822 F 561.819.5823

**Learn more at: [www.dermatologymissions.com](http://www.dermatologymissions.com)**

## Special Events

### Friday, April 28

#### Continental Breakfast

Continental breakfast will be provided to all meeting attendees from 7:00 – 7:30 am in the General Session room (Imperial Ballroom B, Level 2).

#### New Member and First-Time Attendee Welcome Session

If you are new to ASMH, or if this is your first Annual Meeting, plan to attend this informative session from 7:00-7:30 am in the General Session room (Imperial Ballroom B, Level 2) to learn more about ASMH and network with new and veteran members.

#### Networking Reception

A networking reception will take place from 5:00 – 6:30 pm in the Exhibit Hall (Yosemite Ballroom, Level 2). Light hors d'oeuvres will be served, along with beer, wine, and soda. Please join us to meet and network with fellow attendees and exhibitors. **Only attendees and registered guests are allowed entrance to the Exhibit Hall.**

### Saturday, April 29

#### Annual Business Meeting (ASMH Members Only)

The ASMH 2017 Annual Business Meeting will be held at 9:00 – 10:00 am in Imperial Ballroom B, Level 2. Breakfast will be provided.

## 2016-2017 Officers and Board Members

### President

Linda R. Cesario, DPM, HT (ASCP)

### Vice President

M. Maureen Gagnot, HT (ASCP)

### Secretary-Treasurer

Sakina A. Sadiq, BS, HT, HTL, QIHC

### Past President

Jeanie Wade, HT (ASCP)

### Board of Directors

Rodney K. Barber, HT  
Daniel H. Gong, MS  
Kathi McAdoo

### ACMS Representative

Paul Bowman, MD, FACMS

## 2016-2017 ASMH Committees

### Program Committee

Robert L. Milewski, HT, *Chair*  
Linda R. Cesario, DPM, HT (ASCP),  
*Co-Chair*  
M. Maureen Gagnot, HT (ASCP)  
Ebony K. Hills, BS, HT (ASCP)  
Cindy Krol  
Kathi McAdoo  
Cassandra E. Riddle, CMA  
Fatat Sleiman, CLT  
Robert Tagliaferro, HT (ASCP)<sup>CM</sup>  
Jeanie Wade, HT (ASCP)

### MTQA Training Initiative Committee

Linda R. Cesario, DPM, HT (ASCP), *Chair*  
Daniel H. Gong, MS

### MTQA Trainers:

Norma L. Anderson, HT (ASCP)  
Joyce L. Bidwell, MA  
Patricia A. Brunelle, HT  
Linda R. Cesario, DPM, HT (ASCP)  
Susan L. Cushing  
Daniel H. Gong, MS  
Marci L. Lorio, RMA  
Reginald M. Manney, HT  
Marilyn McCulloch, CLT  
Stephanie S. Petrow, HT  
Cassandra E. Riddle, CMA  
Ana I. Santos, CMA  
Fatat Sleiman, CLT  
Thomas E. Sturm, HT (ASCP)  
Toni G. Tedrick, RMA  
Deborah A. Theis-Pruett, HT (ASCP)  
Lynn Whitmore, HT (ASCP)



### Professional Headshots

Available **FREE to all meeting attendees** (optional). On Saturday, April 29 from 12:00-2:00 pm in the Exhibit Hall, professional headshots will be taken by our photographer. Images will be sent electronically following the meeting for personal use. All photos will be taken on a first-come, first-served basis until 2:00 pm. Because of high demand at last year's meeting, there will be two photographers taking photos.

## Welcome from the President

Dear Colleagues,

On behalf of the Board of Directors, I welcome you to the ASMH 23rd Annual Meeting in San Francisco at the Hilton San Francisco Union Square. I would like to extend a special welcome to our new members.

The Scientific Program Committee has developed a diverse and informative program, which will appeal to all levels of Mohs technical levels. This year we have a record-breaking number of presentations! Our inaugural pre-conference workshop day will be held prior to the General Session, which will allow members to experience interactive forums while gaining and sharing knowledge with workshop leaders and peers.

Our invited speakers include ASMH members who will be sharing their technical pearls, ACMS members who will be sharing their clinical expertise, and our guest speakers who will impart other valuable knowledge. Thank you to Memorial Sloan Kettering and Mayo Clinic for your large contributions of speakers this year.

I would like to offer my sincere thanks to Robert Milewski, chair of the Scientific Program Committee, the Program Committee members and the workshop leaders for their hard work and enthusiasm in planning another great Annual Meeting. I also thank the many volunteers who are the fabric of our Society. Thank you Mary Randall, ASMH Executive Director, and the staff at Executive Director Inc. for your detailed planning of this event.

As you are seeing in this program and elsewhere, we are introducing a new logo to represent our Society! Our new look represents the new and positive changes happening within the ASMH. I extend my sincere gratitude to Dr. Paul Bowman, ACMS Representative to the ASMH, for helping set the stage for discussion and development of a new logo. I also thank Brett Kell, ASMH Senior Communications Manager, and the Creative Services Department at Executive Director Inc. for creating a vibrant new ASMH brand built around this new logo.

Please join us at the Networking Reception in the Exhibit Hall on Friday evening, where you can make new contacts and visit with old friends. Also, visit the vendors in the Exhibit Hall who will be displaying their products and services that may benefit you and your laboratory.

Enjoy the meeting!

Sincerely,  
Linda Cesario, DPM, HT (ASCP)  
President, ASMH



## Welcome from the Program Chair

Greetings to all the members of the American Society for Mohs Histotechnology and welcome to the 2017 meeting.

The planning committee is enthusiastic to present an added day to our traditional two-day meeting. This added day on Thursday is all workshop presentations. The intention is to provide the attendees with an opportunity to choose topics that appeal more directly to their interests, with adequate time for interactive attention and discussion. There is also the desire to add some fun topics to the meetings. It is never bad to add spice to life and to learn something today that you did not know yesterday. It is hopeful that this will be a valuable addition to the excellent general session presentations and shorter workshops sessions on Friday and Saturday. Continuous improvement is a very good thing for the annual education and interactions of our members.

It is always desired that everyone complete the survey feedback forms. This is especially true this year so that a well-represented evaluation can be made of what works and what does not.

I also wish to invite every member to engage with the Society to add whatever you can. Please voice your opinions, volunteer, prepare and present a topic we have yet to encounter. I cannot emphasize enough how much each person can contribute to the continuous improvement of this organization.

Robert L. Milewski, BS, HT  
Chair, 2017 Annual Meeting Program Committee



# Welcome to our New Members

As of March 31, 2017

Reza Afzalneia  
Deborah T. Anderson, HT (ASCP)  
Ann Marie Andrews, HTL  
Elizabeth Andis  
Audrey Atwell  
Richard Baker, HT (ASCP)  
Eric T. Baltazar, BS, CLS  
Adilene Barrera  
Mark Barron, LVN  
Colleen M. Bauckham, HT  
Yvonne Bell, HT  
Caitlin S. Berger  
Melissa Bohls  
Rick J. Bowens  
Melanie L. Brodeur, HTL  
Emily E. Burch  
Ashlee Canale, RMA  
Candice L. Canepa  
Martin P. Cavanagh, HT  
Joycelyn Chiodi  
Cathi Cline  
Yvette Clinton  
Daniel R. Cole  
Teresa A. Corlija  
Alexandru Croitoru  
Maria Del Mar Blanes Garcia, HTL  
Sherry M. Dirkx, RMA  
Christina C. Duffy  
Ashlee L. Encinas  
Brenda G. Esser  
Lindsey Eubank, HT, CNA  
Jeanne Evans  
Kim C. Ewy, HT (ASCP), MS  
Stephanie L. Facciolo  
Shannon R. Flannery  
Ruby Fortez  
Nicole A. Fowler  
Porcha Frazier  
Rachel Fuller, LPN  
Jovelyn Galapia  
Kristina L. Garrett, CMA  
Brianna Gentile, MA  
Kaitlin Guisti, MA  
Nichole J. Hansen  
Brittani E. Hebenton  
Leif K. Herger  
Lindsay Hodgson  
Kaila A. Hogg, HT  
Heidi M. Howell, HT  
Donna Immel, HT, MA  
Donna S. Ingersoll, BS, HTL, CT (ASCP)  
Caitlyn R. Jones  
Markie K. Karlowsky, LPN

John R. Kashem, HT  
Stefanie La Rosa  
Sheryl L. Lafontaine  
Elisa Loughran, RMA  
Morgan S. Lowery  
Kristina MacDonald  
Erica Mason  
Ashlee A. McGinnis  
Amy Menser  
Jenny L. Morse, HT  
Ashley A. Mroczkowski, CMA  
Terri E. Munday HT  
Suzanne T. Nelson  
Arquidalis Nieves, HT  
Lauren M. Peregrine, CDT  
Karen J. Pfaff, HT (ASCP), BA  
Brian T. Pickett  
Candace F. Pitts  
Lindsey K. Place  
Lauren E. Poynter, HT (ASCP)  
Weiping Pu  
Clint R. Quiroga  
Diane Raimondi  
Katherine L. Remackel, CMA  
Kayleen L. Ring, CCMA  
Rosalinda Rodriguez, CMA  
Elizabeth Ruefer, MA  
Hollie J. Rugari, RMA  
Randa W. Sadek, HTL  
Michelle D. Scarborough  
Robin M. Seaver, MLT/HT (ASCP)CM  
Ashley Semanutusa  
Esther Sierra  
Michelle M. Simcox, LPN  
Meiwei Song  
Randall C. Staggs  
Heather A. Stephens, MA  
Melissa A. Stokes  
Jennifer A. Strickler, LPN  
Jane Teresi  
Jolee T. Thao, HT  
Jacqueline Torres, CMA  
Amber Toupin  
Kelli A. Umscheid, CCMA  
Ashley L. Velez  
Matthew D. Walsh, RMA  
John A. Wierzhowski  
Nastassia L. Williams, HT  
Sherrita L. Williams  
Steven J. Wilson, HT (ASCP)  
Michelle M. Zevotek, LPN  
Mark A. Zumba, HT (ASCP)

## Program-at-a-Glance

Wednesday, April 26		
1:00 – 5:00 pm	Meeting Registration/Information	Salon A (Grand Ballroom Level/3rd Floor)
Thursday, April 27		
6:30 am – 5:00 pm	Meeting Registration/Information	Salon A (Grand Ballroom Level/3rd Floor)
7:15 – 9:45 am	Immunohistochemistry Procedure for Melanoma: A Wet Workshop	Union Square 5-6 (Tower 3, 4th Floor)
7:15 – 9:45 am	Immunohistochemistry Theory and Details for the IHC Lab	Union Square 1-2 (Tower 3, 4th Floor)
8:30 – 9:30 am	Yoga	Union Square 22 (Tower 3, 4th Floor)
9:30 am – 7:30 pm	Exhibit Hall Open	Yosemite Ballroom (Ballroom Level/2nd Floor)
9:45 – 10:00 am	Break in the Exhibit Hall	Yosemite Ballroom (Ballroom Level/2nd Floor)
10:00 am – 12:30 pm	Immunohistochemistry Procedure for Melanoma: A Wet Workshop	Union Square 5-6 (Tower 3, 4th Floor)
10:00 am – 12:30 pm	Theory and Procedures for Routine Staining of Mohs Slides	Franciscan B (Ballroom Level/2nd Floor)
10:00 am – 12:30 pm	Compliance and Regulatory Requirements for the Mohs Lab	Union Square 3-4 (Tower 3, 4th Floor)
12:30 – 1:30 pm	Lunch	Imperial Ballroom B (Ballroom Level/2nd Floor)
1:30 – 4:00 pm	Cryostat-Enhanced Techniques of Embedding and Cutting Tissue for Mohs	Franciscan C (Ballroom Level/2nd Floor)
1:30 – 4:00 pm	Immunohistochemistry Theory and Details for the IHC Lab	Union Square 1-2 (Tower 3, 4th Floor)
1:30 – 4:00 pm	Theory and Procedures for Routine Staining of Mohs Slides	Franciscan B (Ballroom Level/2nd Floor)
1:30 – 4:00 pm	The A to Z of Mohs Procedures: Technical Guidance on Potential Pitfalls	Union Square 3-4 (Tower 3, 4th Floor)
Friday, April 28		
6:30 am – 5:00 pm	Meeting Registration/Information	Salon A (Grand Ballroom Level/3rd Floor)
7:00 – 7:30 am	Continental Breakfast	Imperial Ballroom B (Ballroom Level/2nd Floor)
7:00 – 7:30 am	New Member and First-Time Attendee Welcome Session	Imperial Ballroom B (Ballroom Level/2nd Floor)
7:30 am – 9:45 am	<b>General Session 1</b>	Imperial Ballroom B (Ballroom Level/2nd Floor)
7:30 am	Opening Remarks and Welcome <i>Linda R. Cesario, DPM, HT (ASCP), ASMH President</i>	
7:45 am	Troubleshooting H&E Stain <i>Melinda M. Chow, MS, HT (ASCP)<sup>CM</sup></i>	
8:15 am	Melanoma Staining with MART-1 <i>Sarah Fitzmaurice, MD</i>	
8:45 am	QA and QC in the Mohs Lab <i>Kimberly R. Brock, BS, HT (ASCP)</i>	
9:15 am	Mohs Layers Surgically Removed at a 90 Degree Cut <i>Norma L. Anderson, HT (ASCP); Kathryn R. Miller, BS</i>	
9:45 – 10:00 am	Break in the Exhibit Hall	Yosemite Ballroom (Ballroom Level/2nd Floor)
10:00 am – 12:00 pm	<b>General Session 2</b>	Imperial Ballroom B (Ballroom Level/2nd Floor)
10:00 am	Whole Mount Sections from a Surgeon's Perspective <i>James O. Barlow, MD, FACMS</i>	
10:30 am	Whole Mount Sections from a Technical Perspective <i>Alex G. Lutz, BS</i>	
11:00 am	Troubleshooting Open Forum <i>Robert L. Milewski, HT; Jeanie Wade, HT (ASCP)</i> <i>Drop off questions at the Registration Desk</i>	





## Program-at-a-Glance

Friday, April 28		
11:30 am – 6:30 pm	Exhibit Hall Open	Yosemite Ballroom (Ballroom Level/2nd Floor)
12:00 – 1:00 pm	<b>Lunch in the Exhibit Hall</b>	Yosemite Ballroom/Imperial A seating space for lunch (Ballroom Level/2nd Floor)
1:00 pm – 3:30 pm	<b>General Session 3</b>	Imperial Ballroom B (Ballroom Level/2nd Floor)
1:00 pm	Skin Histology and Common Skin Cancers: The Basics and Beyond <i>Karen Connolly, MD</i>	
1:30 pm	Optimizing Mohs Frozen Sections <i>Jeanie Wade, HT (ASCP)</i>	
2:00 pm	When There's Smoke, There's Fire: False-Negative Tumor-Free Margins Following Mohs Surgery <i>Marc Z. Handler, MD</i>	
2:30 pm	ASCP Board Certification Exam <i>Michelle A. Nelsen, MS, HT/HTL (ASCP)<sup>CM</sup></i>	
3:00 pm	Maintaining Your Cryostat <i>Jim Kovach, Tech One Biomedical</i>	
3:30 – 5:00 pm	Beginner Cryostat Workshop	Franciscan D (Ballroom Level/2nd Floor)
3:30 – 5:00 pm	Advanced Cryostat Workshop	Franciscan C (Ballroom Level/2nd Floor)
3:30 – 5:00 pm	Beginner Immunohistochemistry Workshop	Union Square 5-6 (Tower 3, 4th Floor)
5:00 – 6:30 pm	<b>Networking Reception</b>	Yosemite Ballroom (Ballroom Level/2nd Floor)
Saturday, April 29		
6:30 am – 4:00 pm	Meeting Registration/Information	Salon A (Grand Ballroom Level/3rd Floor)
8:00 am – 2:00 pm	Exhibit Hall Open	Yosemite Ballroom (Ballroom Level/2nd Floor)
7:00 – 8:30 am	Advanced Cryostat Workshop	Franciscan C (Ballroom Level/2nd Floor)
7:00 – 8:30 am	Advanced Immunohistochemistry Workshop	Union Square 5-6 (Tower 3, 4th Floor)
9:00 – 10:00 am	<b>ASMH Business Breakfast Meeting</b> <i>Members only</i>	Imperial Ballroom B (Ballroom Level/2nd Floor)
10:00 am – 12:00 pm	<b>General Session 4</b>	Imperial Ballroom B (Ballroom Level/2nd Floor)
10:00 am	2016 Abstract Award Winner Deep Margin Embedding Errors Due to Bisected Samples <i>Kurt Hemmings</i>	
10:30 am	Immunohistochemistry During Mohs Surgery <i>Christopher J. Arpey, MD, FACMS</i>	
11:00 am	Troubleshooting Open Forum <i>Robert L. Milewski, HT; Jeanie Wade, HT (ASCP)</i> <i>Drop off questions at the Registration Desk</i>	
12:00 – 1:00 pm	Lunch in the Exhibit Hall	Yosemite Ballroom/Imperial A seating space for lunch (Ballroom Level/2nd Floor)

### Whitelist [info@mohstech.org](mailto:info@mohstech.org)!

To ensure you receive important communications from the ASMH including information regarding the Annual Meeting, messages from the President, the e-Newsletter, member surveys and more, add [info@mohstech.org](mailto:info@mohstech.org) to the Safe Senders list in your email account. If you think you may not have received messages from the ASMH, check your Spam or Junk Mail folder and 'whitelist' [info@mohstech.org](mailto:info@mohstech.org) right away!



## Program-at-a-Glance

Saturday, April 29		
1:00 pm – 3:00 pm	<b>General Session 5</b>	Imperial Ballroom B (Ballroom Level/2nd Floor)
1:00 pm	Using Spatial Awareness to Set Patterns During Mohs Surgery <i>Marie A. Tudisco, PhD, HT (ASCP)</i>	
1:30 pm	Strategies for Optimizing Communication in the Mohs Laboratory <i>Matthew C. Fox, MD, FACMS</i>	
2:00 pm	Putting it Back Together – The Complete Package: Clinical/ Histological Correlations and Patient Outcomes <i>Leigh Sutton, MD</i>	
2:30 pm	Seasoned Specialists – Sharing Knowledge <i>Camille J. McKay; Barbara A. Strippoli, HT (ASCP)</i>	
3:00 pm – 3:15 pm	Break in the Exhibit Hall	Yosemite Ballroom (Ballroom Level/2nd Floor)
3:15 – 4:30 pm	<b>General Session 6</b>	Imperial Ballroom B (Ballroom Level/2nd Floor)
3:15 pm	Volunteerism in Mohs <i>Daniel Berg, MD, FACMS</i>	
3:30 pm	Channeling Your Inner MohsGyver <i>Debra L. Keith, HT (ASCP)</i>	
4:00 pm	How to Calibrate and Verify Mohs Laboratory Devices <i>Robert L. Milewski, HT</i>	
4:30 pm	Meeting Adjourned	

## Hotel & Travel Information

### Hotels

#### Hilton San Francisco Union Square

333 O'Farrell Street, San Francisco, CA 94102  
(415) 771-1400  
www.hiltonsanfranciscohotel.com

Check-in time: 3:00 pm; Check-out time: 12:00 pm  
Early check-in and late check-out are subject to availability and approval.

Hilton San Francisco Union Square Parking  
Rates excluding tax (subject to change)  
Self-parking (garage): \$53.58 Valet: \$62.70

#### Parc 55 San Francisco – A Hilton Hotel

55 Cyril Magnin Street San Francisco, CA 94102  
Phone (415) 392-8000  
www.parc55hotel.com

Check-in time: 3:00 pm; Check-out time: 11:00 am  
Early check-in and late check-out are subject to availability and approval.

Parking Garage entrance is adjacent to the main entrance on Cyril Magnin Street. Current rates are listed below:

- Standard size automobiles: \$70.68 including local taxes for 24 hours
  - Oversize vehicles & SUV's: \$82.08 including local taxes for 24 hours
  - Motorcycles: \$28.50 including local taxes
- Self parking: Unavailable

### Airport & Transportation

San Francisco International Airport (SFO)  
(13 miles South of Hilton Union Square)  
(650) 821-8211  
www.flysfo.com

#### Transportation from San Francisco International Airport

For information on numerous transportation options including taxis, shuttles, car service or rentals, rapid rail, commuter rail, buses, and more, visit the 'To & From SFO' page at [www.flysfo.com/to-from/overview](http://www.flysfo.com/to-from/overview).

#### Driving Directions

From SFO Airport, take Highway 101 north and exit at 7th St. Turn right on Folsom St. Then left on 5th St. Cross Market St. and turn left on Ellis St. to Mason St. Garage entrance is on Ellis St. between Mason & Taylor Streets.

#### San Francisco Weather

Average during late April: High: 63°F, Low: 50°F

# Hilton San Francisco Union Square Floor Map

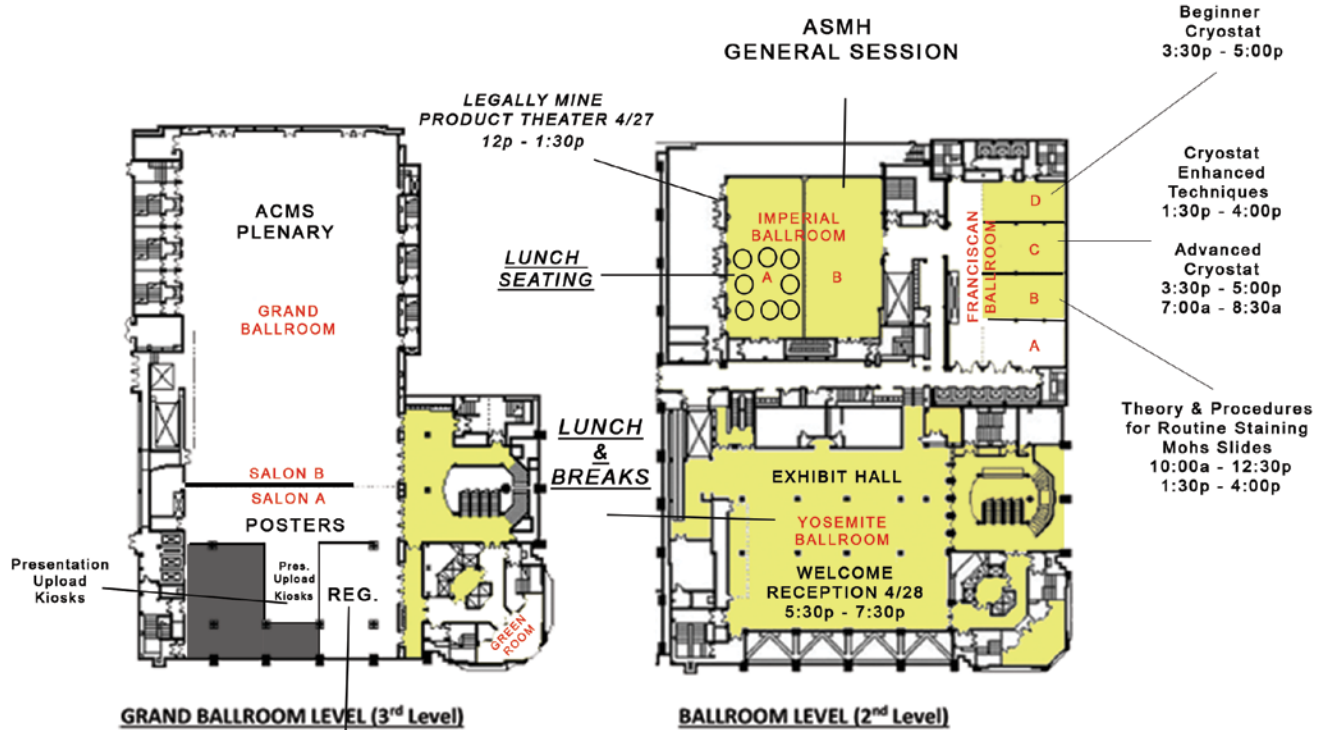

**ASMH Registration and Presentation Upload Kiosks**  
4/27 6:30 am - 5:00 pm  
4/28 6:30 am - 5:00 pm  
4/29 6:30 am - 4:00 pm

*Lunches and Breaks will be served in the Exhibit Hall*  
*Lunch seating available in Imperial A Ballroom*

**IHC**  
**A Wet Workshop**  
7:15a - 9:45a  
10:00a - 12:30p

**IHC**  
**Beginner**  
3:30p - 5:00p  
**Advance**  
7:00a - 8:30a

**IHC**  
**IHC Workshop**  
7:15a - 9:45a  
1:30p - 4:00p

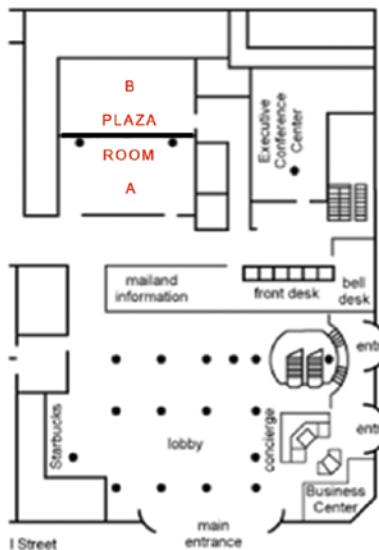
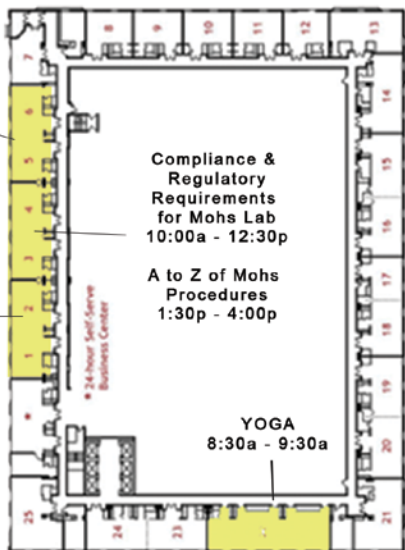

## Pre-Conference Workshops – Thursday, April 27

### Immunohistochemistry Procedure for Melanoma: a Wet Workshop

#### Union Square 5-6 (Tower 3, 4th Floor)

7:15 – 9:45 am OR 10:00 am – 12:30 pm

*Susan Bryant, HT (ASCP), QIHC, Technical Support Specialist, Biocare Medical*

An in-depth and interactive demonstration of slide staining for immunohistochemistry (MART-1) including procedures, equipment and suggested staining protocols. Discussion will include staining questions and the issues involving many aspects of IHC staining as well as troubleshooting pearls. Staining demonstrations and lab instruction will reinforce immunohistochemistry discussion. Materials and slides will be provided for participants.

### Immunohistochemistry Theory and Details for the IHC Lab

#### Union Square 1-2 (Tower 3, 4th Floor)

7:15 – 9:45 am OR 1:30 – 4:00 pm

*Robert L. Milewski, HT*

A presentation of the biochemistry of Immunohistochemical techniques to include how antibodies work and the development of detection systems. Detailed description of pH. Use of a concentrated antibody and how to properly develop and document a working dilution using a micropipette and the advantages/disadvantages of concentrated antibodies versus manufacturer ready-to-use antibodies. Introduction to a variety of antibodies other than MART-1 and their uses in the Mohs laboratory. Note that this workshop will not include the wet staining of slides.

(See Meeting Supplement for outline)

### Yoga

#### Union Square 22 (Tower 3, 4th Floor)

8:30 – 9:30 am

*Kathi McAdoo*

Calling all sore bodies! As Mohs histotechs, we use our large muscle groups all day, but do you know how to care for those muscles? Many of us spend hours standing while we work, and even one day of such work can cause lower back pain. Yoga has been studied and is increasingly recommended to promote relaxation, reduce stress and even reduce or eliminate some medical conditions. Long-term yoga practitioners have also reported musculoskeletal and mental health improvements. Come join us to learn about the benefits of yoga, including easing tension, avoiding the tightening of shoulder and neck muscles, and fighting problems often caused by standing for long hours, such as varicose veins, slouching, and fatigue. We will also learn effective breathing to increase oxygen levels, lower stress, and improve your overall well-being. This will be a fully immersive class, so please bring a towel and wear comfortable clothing that you can move freely in. Beginners welcome and encouraged to attend.

### Theory and Procedures for Routine Staining of Mohs Slides

#### Franciscan B (Ballroom Level, 2nd Floor)

10:00 am – 12:30 pm OR 1:30 – 4:00 pm

*Barbara A. Strippoli, HT (ASCP)*

A presentation of typical staining for the screening of Mohs frozen sections. This will include the chemistry and history of various stains (monochromatic, polychromatic, progressive, regressive), how they color tissue, suggested protocols, and troubleshooting problems. Participants are encouraged to bring in stained slides for troubleshooting. Note that this workshop will not include the wet staining of slides.

### Compliance and Regulatory Requirements for the Mohs Lab

#### Union Square 3-4 (Tower 3, 4th Floor)

10:00 am – 12:30 pm

*Linda R. Cesario, DPM, HT (ASCP); M. Maureen Gagnot, HT (ASCP); Daniel H. Gong, MS, MSO, C-PM; Jeanie Wade, HT (ASCP)*

This workshop will offer a comprehensive discussion and open forum on CLIA and CAP compliance and regulatory requirements for the Mohs Laboratory. Participants are encouraged to bring their procedure manuals for review by an experienced compliance panel, along with suggested modifications.

### Cryostat-Enhanced Techniques of Embedding and Cutting Tissue for Mohs

#### Franciscan C (Ballroom Level/2nd Floor)

1:30 – 4:00 pm

*Robert Tagliaferro, HT (ASCP)<sup>CM</sup>*

This workshop will give direct guidance and advice from experienced technicians on varying enhancements, problems, and refinements to your technique to take back to your Mohs lab. Cryostat embedding, sectioning, and grossing techniques and maintenance will be covered.

(See Meeting Supplement for outline and presentation)

### The A to Z of Mohs Procedures: Technical Guidance on Potential Pitfalls

#### Union Square 3-4 (Tower 3, 4th Floor)

1:30 – 4:00

*Guy E. Orchard, PhD, MSc, FIBMS; Mohammad Shams*

This workshop will focus on debate and discussion of participants' Mohs technical problems, along with suggested remedies. See [mohstech.org/annual-meeting](http://mohstech.org/annual-meeting) for details on submitting slides in advance. A presentation encompassing all the common artifacts seen in Mohs laboratories and how best to troubleshoot and avoid these occurring will also be given.

Workshop attendees are eligible for CEUs through the National Society for Histotechnology, in addition to, CEUs from the General Session/Workshops during the Annual Meeting.



# Improve Your Skills as a Mohs Tech

Thursday, October 12 - Friday, October 13  
Avantik Training Campus, Springfield, New Jersey

ASMH members: \$750 / Non-members: \$1,000  
\$50 discount per trainee for practices sending more than one tech

*Registration closes September 29; no refunds after this date*

Through its Mohs Technician Quality Assurance (MTQA) Training Initiative, the American Society for Mohs Histotechnology is offering a customized training program exclusively to technicians currently working for ACMS member surgeons. This on-site training, which is the only ACMS-approved program of its kind, will include lecture and hands-on instruction on mapping and inking, embedding, staining, cryosectioning, CLIA regulations, troubleshooting, and more.

Upon completion, trainees can claim 12 CEUs through the National Society for Histotechnology and will receive a certificate of completion from the ASMH/ACMS.

For details, hotel reservations, and to register, visit  
[www.mohstech.org/mtqa17](http://www.mohstech.org/mtqa17)



Mohs Surgery Career Center  
[careers.mohscollege.org](http://careers.mohscollege.org)

Enter Keyword or Job Title

All States

Find a Job

**ACMS**  
American College of Mohs Surgery

**ASMH**  
American Society for Mohs Histotechnology

## JOB SEEKERS:

- › Search & apply to relevant positions
- › Set up Job Alerts
- › Create a profile or upload your resume
- › Mobile friendly: phones, tablets, laptops

## EMPLOYERS:

- › Get exposure to the most highly-qualified candidates
- › Search resume database
- › Discounted pricing for single posts or packages
- › Fill jobs more quickly than with conventional sites

# Scientific Program – Friday, April 28

7:30 am – 9:45 am

## General Session 1

Imperial Ballroom B (Ballroom Level/2nd Floor)

7:30 – 7:45 am

### Opening Remarks and Welcome

Linda R. Cesario, DPM, HT (ASCP), ASMH President

7:45 – 8:15 am

### Troubleshooting H&E Stain

Melinda M. Chow, MS, HT (ASCP)<sup>CM</sup>

Hematoxylin and Eosin stain is considered the gold standard which has been used for over a century for the clinical diagnosis in the histopathology laboratory. Since this is the most routine stain, the problems associated with it are often overlooked. Topics discussed will include an overview of the chemistry behind the mechanism of hematoxylin and eosin and how to troubleshoot the common problems associated with this stain; understanding the causes/complaints of the problems and learning how to correct them; and the pros and cons in manual vs. automated H&E staining.

8:15 – 8:45 am

### Melanoma Staining with MART-1

Sarah Fitzmaurice, MD

Topics discussed will include why MART-1 staining should be used; a review of protocol for MART-1 staining of melanoma; tips to help your Mohs surgeon decipher MART-1 stains; common mistakes with MART-1 and how to fix them; and how to get started.

8:45 – 9:15 am

### QA and QC in the Mohs Lab

Kimberly R. Brock, BS, HT (ASCP)

What will make your CLIA surveyor smile? Say what you're going to do. Do what you say. Be able to prove it with documentation. Suggestions for organization and examples of documentation will be included.

9:15 – 9:45 am

### Mohs Layers Surgically Removed at a 90 Degree Cut

Norma L. Anderson, HT (ASCP); Kathryn R. Miller, BS

The 90° cut specimens can be challenging to manipulate and flatten. Presenters will each describe their own process in manipulating and flattening these specimens using two different methods of preparation for embedding using the Slide Method.

(See Meeting Supplement for handouts)

9:45 – 10:00 am

### Break in the Exhibit Hall

Yosemite Ballroom (Ballroom Level/2nd Floor)

10:00 am – 12:00 pm

## General Session 2

Imperial Ballroom B (Ballroom Level/2nd Floor)

10:00 – 10:30 am

### Whole Mount Sections from a Surgeon's Perspective

James O. Barlow, MD, FACMS

The many advantages and unique limitations of using whole mount sections as the standard approach for processing Mohs tissue specimens will be reviewed.

10:30 – 11:00 am

### Whole Mount Sections from a Technical Perspective

Alex G. Lutz, BS

The pros, cons, and considerations of processing Mohs cases whole from a Mohs technician's perspective will be discussed, along with examples and best practices.

11:00 am – 12:00 pm

### Troubleshooting Open Forum

Robert L. Milewski, HT; Jeanie Wade, HT (ASCP)

Meeting attendees, both new and experienced, are encouraged to attend this open-format discussion for tips, tricks and techniques from fellow Mohs technicians. Questions and concerns can be submitted anonymously and dropped off in advance at the Registration Desk or presented in person during the forum.

12:00 – 1:00 pm

### Lunch in the Exhibit Hall

Yosemite Ballroom / Imperial A seating space for lunch (Ballroom Level/2nd Floor)

1:00 – 3:30 pm

## General Session 3

Imperial Ballroom B (Ballroom Level/2nd Floor)

1:00 – 1:30 pm

### Skin Histology and Common Skin Cancers: The Basics and Beyond

Karen Connolly, MD

This session will provide an overview of basic and advanced skin histology. Clinical and histopathological features of common and rare skin tumors treated by Mohs Micrographic Surgery will also be reviewed.

1:30 – 2:00 PM

### Optimizing Mohs Frozen Sections

Jeanie Wade, HT (ASCP)

Mohs case specimens come in a variety of shapes and sizes. Technical tips offer an insight on how to acquire a quality representative section based on tissue type, section thickness, section completion, fat, cartilage, artifacts, quality staining, etc., as well as equipment used in the lab, to enable you to implement the most perfect, effective and functional method possible.

2:00 – 2:30 pm

### When There's Smoke, There's Fire: False-Negative Tumor-Free Margins Following Mohs Surgery

Marc Z. Handler, MD

Mohs micrographic surgery has the highest cure rate for skin cancer treatment. Although recurrence is rare, a false negative may occur in certain situations. One such situation is taking the initial layer in the same location as the biopsy scar. This may produce a false negative, known as the doughnut sign.

## Scientific Program – Friday, April 28

2:30 – 3:00 pm

### ASCP Board of Certification Exam

*Michelle A. Nelsen, MS, HT/HTL (ASCP)CM*

This presentation will discuss the benefits of ASCP certification, outline the requirements for the HT and HTL board exams, and provide tips on how to study and prepare for the exam.

3:00 – 3:30 pm

### Cryostat Maintenance and Repair

*Jim Kovach, Tech One Biomedical*

Maintaining your cryostat, as well as what you can do when it's not working properly, before calling for service, will be discussed.

## Scientific Program – Saturday, April 30

9:00 – 10:00 am

### ASMH Business Breakfast Meeting & Breakfast\*

**Imperial Ballroom B (Ballroom Level/2nd Floor)**

Business meeting to announce 2017 Board of Directors election results, ASMH year in review, as well as plans and goals for the coming year.

*\*Breakfast will be served during the business meeting only. ASMH Members Only*

10:00 am – 12:00 pm

### General Session 4

**Imperial Ballroom B (Ballroom Level/2nd Floor)**

10:00 – 10:30 am

### 2017 Abstract Award Winner (see page 15 for details)

#### Deep Margin Embedding Errors Due to Bisected Samples

*Kurt Hemmings*

The literature promotes the idea that the vertically cut sides of multisectioned layers are a source of embedding errors by compressing and/or rolling over. A short prospective study demonstrates that keeping a consistent sectioning angle (no readjusting of the object holder) and a consistent depth between sections dwarfs these errors.

10:30 – 11:00 am

### Immunohistochemistry During Mohs Surgery

*Christopher J. Arpey, MD, FACMS*

Indications for immunohistochemistry in selected cases of Mohs surgery with practical tips will be reviewed. The main focus will be on MART-1 for lentigo maligna, MCK for difficult squamous cell carcinoma, and CK-7 for extramammary Paget's disease.

(See Meeting Supplement for handouts)

11:00 am – 12:00 pm

### Troubleshooting Open Forum

*Robert H. Milewski, HT; Jeanie Wade, HT (ASCP)*

This is an additional trouble shooting session to address questions not answered in the Friday session and newly submitted questions and discussions. Meeting attendees, both new and experienced, are encouraged to attend this open-format discussion for tips, tricks and techniques from fellow Mohs technicians. Questions and concerns can be submitted anonymously and dropped off in advance at the Registration Desk or presented in person during the forum.

12:00 – 1:00 pm

### Lunch in the Exhibit Hall

**Yosemite Ballroom / Imperial A** seating space for lunch  
(Ballroom Level/2nd Floor)

1:00 – 3:00 pm

### General Session 5

**Imperial Ballroom B (Ballroom Level/2nd Floor)**

1:00 – 1:30 pm

### Using Spatial Awareness to Set Patterns During Mohs Tissue Processing

*Marie A. Tudisco, PhD, HT (ASCP)*

Using visual aids, this presentation will explain the organized awareness of objects in relation to our body and the space around us, as well as tracking objects as they change position in space and developing patterns of organization during Mohs tissue processing with an emphasis on maintaining specimen orientation from start to finish by using spatial awareness.

1:30 – 2:00 pm

### Strategies for Optimizing Communication in the Mohs Laboratory

*Matthew C. Fox, MD, FACMS*

Effective communication among members of the Mohs team is crucial, particularly in the laboratory. In this session, practical strategies to optimize communication while building a high-quality laboratory team will be reviewed.

2:00 – 2:30 pm

### Putting it Back Together – The Complete Package: Clinical/Histological Correlations and Patient Outcomes

*Leigh Sutton, MD*

The practical implications of histological slides will be discussed, along with cases that illustrate the importance of quality slides that lead to the high cure rates of Mohs micrographic surgery.

## Scientific Program – Saturday, April 30

2:30 – 3:00 pm

### Seasoned Specialists Sharing Knowledge

*Camille J. McKay; Barbara A. Strippoli, HT (ASCP)*

Sharing experiences as Mohs professionals helps entry-level techs interact with seasoned techs and gain knowledge that cannot be gained through a formal education. The presenters have diverse backgrounds as Mohs/histology professionals and will share their past experiences with the audience.

3:00 – 3:15 pm

### Break

**Yosemite Ballroom (Ballroom Level/2nd Floor)**

3:15 – 4:30 pm

### General Session 6

**Imperial Ballroom B (Ballroom Level/2nd Floor)**

3:15 – 3:30 pm

### Volunteerism in Mohs

*Daniel Berg, MD, FACMS*

The presenter's experience and lessons from performing volunteer Mohs surgery overseas (Eastern Europe, Central and South America) will be briefly reviewed.

(See Meeting Supplement for handouts)

3:30 – 4:00 pm

### Channeling Your Inner MohsGyver

*Debra L. Keith, HT (ASCP)*

Mohs techs are GREAT at thinking quickly and responding to tricky cases. This presentation covers a few creative answers to questions like "Do I have all of the epidermis?" and "Can I make a perfect slide with fat?"

(See Meeting Supplement for handouts)

4:00 – 4:30 pm

### How to Calibrate and Verify Mohs Laboratory Devices

*Robert L. Milewski, HT*

This presentation will cover methods to calibrate and verify devices to comply with CAP, CLIA, and other regulatory agencies to include: Cryostats, thermometers, timers, micropipettes, pH meters, weighing scales, reagents, controls, and newly established procedures utilizing NIST standards, ISO standards, and time keeping contacts. Examples of documentation will be viewed and are available upon request.

## Cryostat and Immunohistochemistry Workshop Details

The following workshops require a separate ticket for entry.

### Cryostat Workshops

#### Beginner Cryostat – Franciscan D (Ballroom Level/2nd Floor)

Friday, April 28, 3:30 – 5:00 pm

*Robert Tagliaferro, HT (ASCP)<sup>CM</sup>*

Receive direct guidance and advice from experienced workshop volunteers to learn tips and refine techniques that will help you with cryostat use in the Mohs lab. Cryostat embedding and cutting techniques and maintenance will also be covered.

#### Advanced Cryostat – Franciscan C (Ballroom Level/2nd Floor)

Friday, April 28, 3:30 – 5:00 pm OR Saturday, April 29, 7:00-8:30 pm

*Jeanie Wade, HT (ASCP) OR Robert Tagliaferro, HT (ASCP)<sup>CM</sup>*

An in-depth presentation on processing full thickness wedge specimens, provide instructions on how to acquire a complete representative section of fatty (non-cutting) type tissue, how to manipulate the contours of cartilage and to transition epidermis to an even plane with the deep margin.

### Immunohistochemistry Workshops

#### Beginner Immunohistochemistry – Union Square 5-6 (Tower 3, 4th Floor)

Friday, April 28, 3:30 – 5:00 pm

*Susan Bryant, HT (ASCP), QIHC, Technical Support Specialist, Biocare Medical*

A demonstration of staining for MART-1 including explanation of reagents, equipment and staining protocols. Experienced workshop volunteers will assist attendees with the technique of MART-1 staining.

#### Advanced Immunohistochemistry – Union Square 5-6 (Tower 3, 4th Floor)

Saturday, April 29, 7:00 – 8:30 am

*Susan Bryant, HT (ASCP), QIHC, Technical Support Specialist, Biocare Medical*

A demonstration of staining for MART-1 including explanation of reagents, equipment, staining protocols, troubleshooting techniques and additional antibody options. Experienced workshop volunteers will assist the attendees with the technique of MART-1 staining.

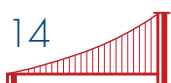



# 2017 Abstract Award Winner

## Deep Margin Embedding Errors Due to Bisected Samples

Kurt Hemmings

Saturday, April 29, 10:00 – 10:30 am

### Subject:

The literature promotes the idea that the vertically cut sides of multisectioned layers are a source of embedding errors and that these errors are often caused by tissue compression or rolling, (Derm Surgery, and BMC Derm have had several articles over the years).

### Methods:

What's the true story of a map like this? Is it a positive dot in the centre or is most of the deep involved?



What's the error, tangential cuts or the edges sloping?

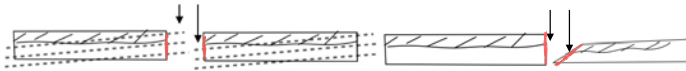

Tangential sections present a deep (on one side) and a shallow (on the other side) aspect of the block in the same cut. Max disagreement at adjacent sides( red inked edges) is at the arrows showing in this case the third cut into each block.

Vs

Compressed or rolled tissue creates a sloped edge that brings the deeper (tumor) structures closer to the face of the block. These deeper structures can now be reached with shallower cuts.

60 random cases are bisected (or nearly so) but are embedded together so to be sectioned in tandem(see below).

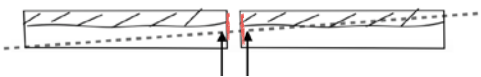

If both samples are placed together and sectioned together then the depth of the section is as close to equal at the side.

With dedicated practice an experienced tech can cut into a block face relatively squarely but still this problem presents itself. In order to eliminate any additional tangential element of sectioning, once a cut is made into the block no further adjustments are made and serial sections are harvested for evaluation. The slides were then read and mapped out as to early, mid and late sections.

### Results:

Of the cases tallied, the non matching examples are of the most interest. The 3 that matched only in the early cuts show how if one side is more compressed than the other it transitions into the positive region more rapidly. The offset samples are in principle a match as the proportional area is the same( its just stretched or scaled up) but are placed in the unmatched as they are not a perfect match. The unmatched needs no clarification and the inconclusive samples had such a homogeneous structure that it was hard to determine a difference in depth.

From the numbers its clear that edge rolling or compression is not the primary issue, 7 samples that didn't matchup compared to 51 that did. As for further testing of tangential sectioning it would be difficult to maintain a consistent angular error throughout the study but such an error could be calculated retrospectively by simply comparing early vs later cuts.

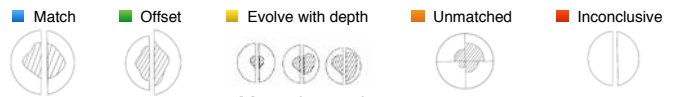

### Mapped samples

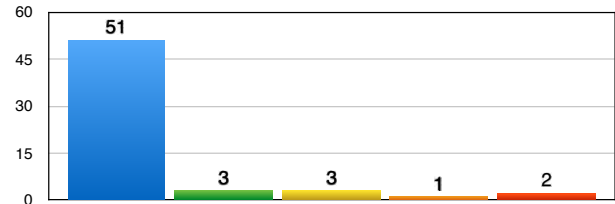

### Conclusion:

Keep angles constant once into the block and keep the depth between harvested sections consistent. Overly compressed tissue is still a significant (app 12%) error but not changing cutting angle is paramount. Let's give our surgeons the most valid slides possible.

# Thank You

ASMH expresses sincere appreciation to all speakers, session participants, and workshop volunteers for their contribution to the meeting program:

## Speakers & Presenters

Norma L. Anderson, HT (ASCP)  
Christopher J. Arpey, MD, FACMS  
James O. Barlow, MD, FACMS  
Daniel Berg, MD, FACMS  
Kimberly R. Brock, BS, HT (ASCP)  
Melinda M. Chow, MS, HT (ASCP)<sup>CM</sup>  
Karen Connolly, MD  
Sarah Fitzmaurice, MD  
Matthew Fox, MD  
Marc Z. Handler, MD  
Kurt Hemmings  
Debra L. Keith, HT (ASCP)  
Jim Kovach  
Alex G. Lutz, BS  
Camille J. McKay  
Robert L. Milewski, HT  
Kathryn Miller, BS  
Michelle A. Nelsen, MS, HT/HTL (ASCP)<sup>CM</sup>  
Barbara A. Strippoli, HT (ASCP)  
Leigh Sutton, MD  
Marie H. Tudisco, PhD, HT (ASCP)  
Jeanie Wade, HT (ASCP)

## Workshop Associate Trainers

Norma L. Anderson, HT (ASCP)  
Rodney K. Barber, HT  
Joyce L. Bidwell, MA  
Kimberly R. Brock, MS, HT (ASCP)  
Bobbie Bruett, HT  
Patricia A. Brunelle, HT  
Melinda M. Chow, MS, HT (ASCP)<sup>CM</sup>  
Debra L. Keith, HT (ASCP)  
Colleen M. Kukuk, HT (ASCP)  
Marci L. Lorio, RMA  
Kathi McAdoo  
Marilyn McCulloch, CLT  
Stephanie S. Petrow, HT  
Cassandra E. Riddle, CMA  
Thomas E. Sturm, HT (ASCP)  
Toni G. Tedrick, RMA

## ASMH Thanks Its Supporters

The American Society for Mohs Histotechnology gratefully acknowledges the following companies for their contributions and support to help underwrite the educational goals of the ASMH Annual Meeting.



Cryostats  
Workshop Supplies  
Registration Bags



Lanyards



Workshop Leadership and Supplies



Microscopes



Cryostats



Workshop Supplies

# Exhibit Hall Floor Plan

The Exhibit Hall is located in the Yosemite Ballroom (Ballroom Level/2nd Floor)

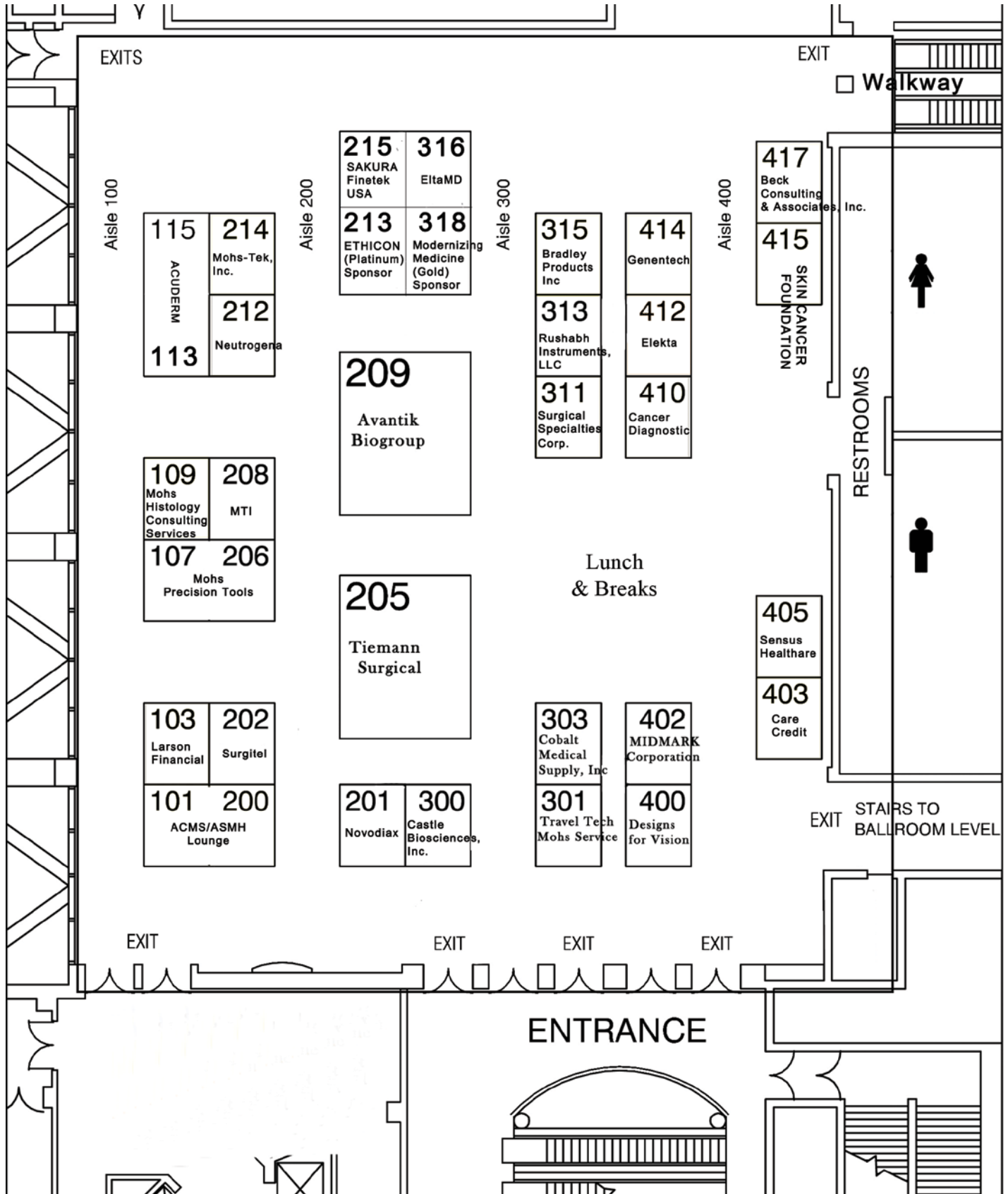

# Exhibitor Listing

(As of April 1, 2017)

Attendees are encouraged to visit the technical exhibits during the ASMH Annual Meeting. A variety of companies of interest to Mohs histotechnologists and surgeons will be displaying their products, equipment, and services. Please be sure to visit the Exhibit Hall to learn about their quality offerings.

## Exhibit Hall Hours

Thursday, April 27: 9:30 am – 7:30 pm  
Friday, April 28: 9:30 am – 6:30 pm  
Saturday, April 29: 9:00 am – 4:00 pm

### 113, 115 Acuderm

5370 NW 35th Terrace, Suite 106  
Ft. Lauderdale, FL 33309  
P (954) 733-6935  
jkroop@acuderm.com  
www.acuderm.com

Acuderm is proud to have been serving dermatologists with high quality, made in the USA, disposable instruments for more than 30 years. New to our brand are our top quality reusable surgical instruments made in Germany at significant savings! We invite you to feel the difference! As with all our products, we offer 100% satisfaction guarantee! When you think high quality instruments, think Acuderm!

### Island 209 Avantik Biogroup (Sponsor)

36 Commerce St. | PO Box 619  
Springfield, NJ 07081-0619  
P (973) 912-8900 ext. 159  
F (973) 232-0077  
sean.gallagher@avantik-us.com  
www.avantik-us.com

Avantik Biogroup is dedicated to providing solutions for Mohs laboratories with quality new instruments like the revolutionary Avantik QS12 Cryostat, fully remanufactured instruments with the best warranty in the industry, and a large selection of Avantik quality consumable goods from reagents and stains to slides and coverslips. From Mohs lab design, planning and set-up, to the industry's most attentive service and support, Avantik Biogroup is the only true choice for your Mohs laboratory!

### Beck Consulting & Associates, Inc.

1220 Nettles Blvd.  
Jensen Beach, FL 34957  
P (828) 369-2315  
F (800) 282-3015  
histobarb@msn.com  
www.beck-us.com

Beck Consulting provides the only accredited program for technical training and consulting for Mohs and Histology laboratories for more than 15 years! We offer complete technical assistance and training for Mohs and Histology, as well as the ability to train on your own equipment in your own office, or one of our workshops. Become proficient in cutting Mohs and Histopathology sections, and experience full lab setups for both Derm Path and Mohs. Training includes CLIA/OSHA documentation. We have 623 labs set up to date with zero deficiency ratings, and can create a procedure manual specific to your lab. Ask for our available references!

### 315 Bradley Products, Inc.

1700 West 94th St.  
Minneapolis, MN 55431  
P (952) 881-1430  
solson@bradleyproducts.com  
www.bradleyproducts.com

Bradley Products is the manufacturer of The Davidson Marking System, the first tissue marking system specifically developed for orienting specimens. Economical, efficient, visible, reliable and safe, Davidson Marking System marking dyes have been used since 1984 and are CE marked for Europe. DMS dyes are appropriate for fresh or frozen tissue.

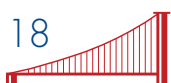

## Exhibitor Listing

### 410 Cancer Diagnostics, Inc.

4300 Emperor Blvd., Suite 400  
Durham, NC 27703  
P (877) 846-5393  
info@cancerdiagnostics.com  
www.cancerdiagnostics.com

Please request your free sample bottle of UltraFreeze OCT Compound and CDI's Tissue Dyes at our booth. Founded in 1998, Cancer Diagnostics, Inc. (CDI) developed the first commercially available 7-dye color kit for marking tissue margins, CDI's Tissue Marking Dyes, and today offers one of the industry's largest anatomical pathology/Mohs portfolios of products to more than 3,500 customers. Explore our newest catalog and find out what makes CDI the fastest-growing supplier to the worldwide anatomical pathology and Mohs market.

### 403 CareCredit

2995 Red Hill Ave., Suite 100  
Costa Mesa, CA 92626  
P (714) 434-4532  
gina.chang@carecredit.com  
www.carecredit.com

CareCredit has helped millions of patients receive needed and desired care. CareCredit is a health and wellness credit card offering promotional financing options, ideal for co-pays and insurance deductibles. From laser treatments and injectables to Mohs surgery, we help patients access dermatologic care. For more information, call (800) 300-3046 or visit [www.carecredit.com](http://www.carecredit.com).

### 300 Castle Biosciences, Inc.

820 S. Friendswood Dr., Suite 201  
Friendswood, TX 77546  
P (866) 788-9007  
F (866) 431-2924  
conferences@castlebiosciences.com  
www.castlebiosciences.com

Castle Biosciences, Inc. is a cancer-focused molecular diagnostics company dedicated to helping patients and their physicians make the best possible decisions about their treatment and care based on the individual molecular signature of their tumor. DecisionDx/Melanoma is a new test that identifies metastatic risk in melanoma patients ([www.SkinMelanoma.com](http://www.SkinMelanoma.com)).

### 303 Cobalt Medical Supply, Inc.

PO Box 367  
Pequannock, NJ 07440  
P (973) 305-0730  
mmazon@cobaltmed.com  
www.cobaltmed.com

Cobalt is a full line provider of surgical and clinical equipment, instruments and supplies to complement the needs of the dermatologist and surgeon. We match great service with high-quality products to assist our clients with the many needs and challenges they have.

### 400 Designs For Vision, Inc.

760 Koehler Ave.  
Ronkonkoma, NY 11779  
P (631) 585-3300  
F (631) 585-3404  
conventions@dvimail.com  
www.designsforvision.com

Just See It™ with Designs for Vision's lightweight custom-made surgical Telescopes- now available with Nike® frames. See It Even Better™ with the L.E.D Daylite® or Twin Beam® L.E.D. Daylite® providing the brightest and safest un-tethered illumination. Introducing the L.E.D. Daylite® Nano Cam HD document procedure and HD video from your perspective.

### 412 Elekta

400 Perimeter Center Terrace, Suite 50  
Atlanta, GA 30346  
P (770) 670-2374  
lori.minton@elekta.com  
www.elekta.com

Elekta develops significant innovations and clinical solutions for the treatment of cancer and brain disorders. Esteya® electronic brachytherapy is Elekta's new patient-friendly solution for treating skin cancer. Esteya can be used anywhere in the clinic, has a favorable procedure time and offers user-friendly operation. Learn more about the system at [www.esteya.com](http://www.esteya.com).

### 316 EltaMD Skincare

2055 Luna Rd. #126  
Carrollton, TX 75006  
P (317) 442-8226  
pdorman@eltamd.com  
www.eltamd.com

EltaMD® product development expertise is based on our medical heritage. EltaMD applies that experience to create innovative products that help develop, protect and maintain healthy skin. Available through your dispensing physician, EltaMD sun care and skin care products are formulated for every skin type, lifestyle and special need.

### 213 Ethicon, Inc. (Platinum Sponsor)

US Route 22 West  
Somerville, NJ 08876  
P (908) 218-2214  
sarshons@its.jnj.com  
www.ethicon.com

Ethicon US LLC, brings to market a broad range of innovative surgical products, solutions and technologies used to treat some of today's most prevalent medical issues, such as colorectal and thoracic conditions, spine and cardiovascular conditions, cancer, obesity and other conditions requiring general surgery.

## Exhibitor Listing

### 414 Genentech

1 DNA Way  
South San Francisco, CA 94080  
P (650) 255-2169  
emusser@gene.com  
www.gene.com

For more than 40 years, we've been following the science, seeking solutions to unmet medical needs. As a proud member of the Roche Group, we make medicines to treat patients with serious medical conditions.

### 103 Larson Financial

1015 Corporate Square Dr., Suite 300  
St. Louis, GA 63132  
P (989) 941-7119  
matthew.dodge@larsonfinancial.com  
www.larsonfinancial.com

Larson Financial is a nationwide wealth management firm specializing in physicians and their families. We are committed to helping our clients understand each step of a comprehensive planning process. We share practical solutions that can be used to help you, your practice and family create and protect your wealth.

### Product Theater 4/27/17

### Legally Mine

225 W 520 N  
Orem, UT 84057  
P (801) 477-1772  
april@legallymineusa.com  
www.legallymineusa.com

The mission of Legally Mine is to empower members of the healthcare and business communities with knowledge and tools to protect their assets from lawsuits, legitimately reduce their tax liability, and cultivate an environment wherein they can thrive financially. Legally Mine is a full-service legal structuring company which provides documents, service, implementation and support for the asset protection, and tax reduction needs of each of our clients.

### 402 Midmark Corporation

60 Vista Dr.  
Versailles, OH 45380  
P (800) 643-6275  
F (800) 365-8631  
felsass@midmark.com  
www.midmark.com

Midmark Corporation is committed to providing innovative products and solutions to healthcare professionals around the world. Offering full lines of exam and procedures tables, as well as workstations, casework, instrument processing, digital diagnostic solutions and more. Midmark is focused on continuously improving physician workflows and enhancing patient-caregiver interactions.

### 318 Modernizing Medicine (Gold Sponsor)

3600 FAU Blvd., Suite 202  
Boca Raton, FL 33431  
P (561) 880-2998 x1615  
amy.horn@modmed.com  
www.modmed.com/dermatology/

Modernizing Medicine is transforming how healthcare information is created, consumed and utilized to increase efficiency and improve outcomes. The company's product, Electronic Medical Assistant® (EMA™), is a cloud-based, specialty-specific electronic medical record (EMR) system with a massive library of built-in medical content and coding expertise, designed to save physicians time.

### 109 Mohs Histology Consulting Services

2507 S. Manito Blvd.  
Spokane, WA 99203  
P (509) 954-7134  
mickie25@netzero.net  
www.mohshistologyconsulting.com

Mohs Histology Consulting Services has a 15-year record of excellence in providing new Mohs laboratories with planning, equipment selection and placement, as well as a complete CLIA manual and accredited Mohs technician training with certification. We have set up many labs from scratch and trained hundreds of technicians. You won't be disappointed in our exemplary service. We are often called back for additional training when the need arises.

### 107 & 206 Mohs Precision Tools

1690 Saint Joseph East  
Montreal, Quebec H2J 1M9 Canada  
P (844) 288-6647  
khemmings@mohsprecisiontools.com  
www.mohsprecisiontools.com

Mohs Precision Tools is a pioneer in addressing alignment issues in cryostats. The True Margin is the only device that aligns the tissue plain to the microtome blade. We offer cryotomy solutions for busy Mohs surgeons, perfect sections are our passion.

### 214 MohsTEK, Inc. (Sponsor)

11758 Willard Ave.  
Tustin, CA 92782  
P (949) 559-6647  
F (949) 559-6647  
radhasee@yahoo.com  
www.mohstek.com  
www.biopsyprep.com

MohsTEK has dedicated 25 years to our own oath to keep the highest quality, fastest speeds, and hands down some of the best customer service around. MohsTEK offers its very own Mohs technicians, in-house biopsy prep lab, highest-quality frozen and paraffin section slides, in-house transportation services, and much more.



## Exhibitor Listing

### 208 MTI

3655 Ninigret Dr.  
Salt Lake City, UT 84093  
P (801) 875-4903  
F (801) 952-0548  
matthew.baker@mti.net  
www.mti.net

MTI's products are perfect for any Dermatologist. Our chairs and tables include the 430, 429, 428, 450, 450W, 410, 424, and 423 models. Depending on the model, some features include power Lift/Back/Tilt/Foot, optional 340° swivel base, 20", 22", or 24" tapered or squared backrest, premium velcro-attached upholstery and limitless accessories.

### 212 Neutrogena

14119 Hambleton Dr.  
Houston, TX 77069  
P (713) 302-3653  
deanne.smith@inventivhealth.com  
www.neutrogenamd.com

The Neutrogena® Brand, one of the brands of Johnson & Johnson Consumer Inc., advances skin and hair care science through continuous support of the medical community and through the development of clinically proven products that deliver real results to physicians, nurses and patients. Please visit our website for dermatology professionals at [www.NeutrogenaMD.com](http://www.NeutrogenaMD.com) for information about recent additions to the Neutrogena® product line.

### 201 Novodiox

3517 Breakwater Ave.  
Hayward, CA 94545  
P (510) 574-7325  
diana@novodiox.com  
www.novodiox.com

Novodiox's mission is to reduce patient suffering and unnecessary medical expenses by providing more precision diagnostics. Novodiox provides pathologists with a series of 10-min IHC products that may be applied to intraoperative tissue examinations, including Pan-Cytokeratin, Mart-1 and SOX-10.

### 313 Rushabh Instruments, LLC

1750A Costner Dr.  
Warrington, PA 18976  
P (215) 491-0081 Ext. 1  
F (215) 491-0080  
preyasshah@att.net  
www.qualityhistology.com

Rushabh Instruments, LLC designs and manufactures high quality medical laboratory equipment. We develop and manufacture products that are innovative, easy to use and work well in your work environment. Our Histology product line currently includes Tissue Embedding Center, H&E Slide Stainer, Frozen Section Stainer for Mohs Labs, Floation Water Bath and Paraffin Dispenser. Our products are designed and built in Warrington, Pennsylvania, USA.

### 215 Sakura Finetek USA, Inc.

1750 W. 214th St.  
Torrance, CA 90501  
P (800) 725-8723  
ahammer@sakuraus.com  
www.sakuraus.com

Sakura Finetek, USA, Inc. offers cryostats, slide staining kits, Cryomolds, OCT Compound and disposable Accu-Edge blades for Mohs labs to help technicians do their work – simply, consistently and productively. Reliability, dependability, and quality are the cornerstones of an unbeatable combination of traditions that span more than two decades of innovation at Sakura.

### 405 Sensus Healthcare

851 Broken Sound Parkway NW, #215  
Boca Raton, FL 33487  
P (561) 922-5808  
jroger@sensushealthcare.com  
www.sensushealthcare.com

Sensus Healthcare is focused on making proven non-melanoma skin cancer solutions more accessible to patients. Our dedicated superficial radiation therapy (SRT) systems are designed specifically to provide an alternative to surgical procedures for basal cell and squamous cell carcinomas. Our mobile, compact SRT-100 systems are used widely by oncologists and dermatologists to bring non-melanoma skin cancer treatment to more patients in more settings. Superficial radiation therapy is also an effective treatment modality for keloids.

### 311 Surgical Specialties Corporation

50 Braintree Hill Office Park, Suite 101  
Braintree, MA 02184  
P (877) 991-1110  
bmatthews@surgicalspecialties.com  
www.surgicalspecialties.com

Quill™ Knotless Tissue-Closure Device allows Mohs surgeons to eliminate tying suture knots in wounds, including high-tension areas. Through its unique barbed design, it can approximate tissue and evenly distribute tension along the incision. The Quill device has also demonstrated time and cost savings when compared to traditional suture.

### 202 SurgiTel/General Scientific Corporation

77 Enterprise Dr.  
Ann Arbor, MI 48103  
P (800) 959-0153  
F (734) 662-0520  
events@surgitel.com  
www.surgitel.com

SurgiTel is the manufacturer of premium loupes and headlamps sold around the world from their headquarters in Ann Arbor, Michigan. Holding a variety of patents, SurgiTel is always on the forefront of vision and ergonomics.

## Exhibitor Listing

### 415 The Skin Cancer Foundation (Sponsor)

149 Madison Ave., Suite 901  
New York, NY 10016  
P (646) 583-7988  
bhanley@skincancer.org  
www.skincancer.org

The Skin Cancer Foundation is the only global organization solely devoted to the prevention, early detection and treatment of skin cancer. The mission of the Foundation is to decrease the incidence of skin cancer through public and professional education and research. Since its inception in 1979, the Foundation has recommended following a complete sun protection regimen that includes seeking shade and covering up with clothing, including a wide-brimmed hat and UV-blocking sunglasses, in addition to daily sunscreen use.

### Island 205 Tiemann Surgical

25 Plant Ave.  
Hauppauge, NY 11788  
P (800) 843-6266  
F (800) 577-6050  
brian@georgetiemann.com  
www.georgetiemann.com

Tiemann will display a full line of surgical instruments and accessories for Mohs surgery. We are experts at assisting the Mohs surgeon assemble surgical trays.

### 301 Travel Tech Mohs Services

1300 223rd. St., #411  
Carson, CA 90745  
P (310) 328-7846  
karen@gotmohs.com  
www.gotmohs.com

Travel Tech Mohs Services, Inc. is a histology technician service specializing in Mohs Micrographic Surgery. We provide all the machinery as well as a skilled professional in Mohs histology. Our team of Mohs technicians have been providing the highest quality Mohs frozen sectioning available for the past 20 years.









# It's Time to Face MIPS

Among the first in the nation to build MIPS performance in the EHR

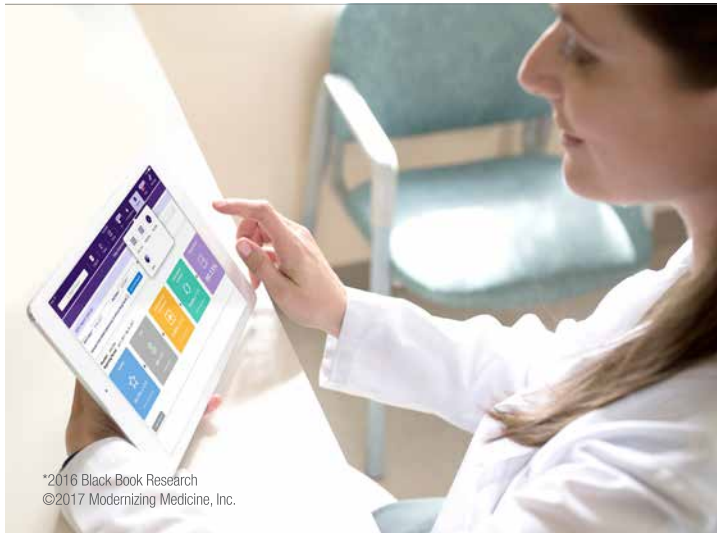

\*2016 Black Book Research  
©2017 Modernizing Medicine, Inc.

EMA™, the #1 dermatology-specific EHR system for 3 consecutive years\*, automatically calculates your MIPS score in real time, showing you how you're doing as a practice and versus your peers. And unlike other companies, you can report on MIPS for the entire year — another advantage that could save you some real money.



**MODERNIZING  
MEDICINE**

modmed.com | 561.235.7501

## Call for Newsletter Submissions

The ASMH is seeking your ideas and submissions for the Summer issue of the ASMH Membership Bulletin e-newsletter. Please consider your recent Mohs lab experiences; are there things you've done or learned that your fellow members may want to know about? Think of successes, tips, tricks or anything else that helps advance our work as Mohs technicians.

Here are a few general ideas to get you thinking:

- **Achievements:** Any recent accomplishments or recognition?
- **Education and certification:** How did you or will you prepare for HT or HTL certification?
- **Trends:** How do you and your colleagues keep up with what's new in the field?
- **Jargon:** What technical shorthand have you picked up, used or created?
- **Equipment:** Any new tools, technology or tips for using them in your lab?
- **Quality Control:** How do you deal with standards, enforcement, charts and more?
- **Records:** Paper or electronic, what do you do to keep clear, organized records?
- **Safety:** How do you ensure safety around chemical and biological hazards in your lab?

The target word count for most pieces is between 300-600 words. Please also think of what visuals you could provide. **Articles are due July 17.** The Summer 2017 e-newsletter is due out in early August. **Email [info@mohstech.org](mailto:info@mohstech.org) with your ideas or submissions.**



Save the Date

ASMH

American Society for  
Mohs Histotechnology

24<sup>TH</sup> ANNUAL MEETING

Friday, May 4 – Saturday, May 5, 2018

CHICAGO